

# Hydraulic Pump HM-506

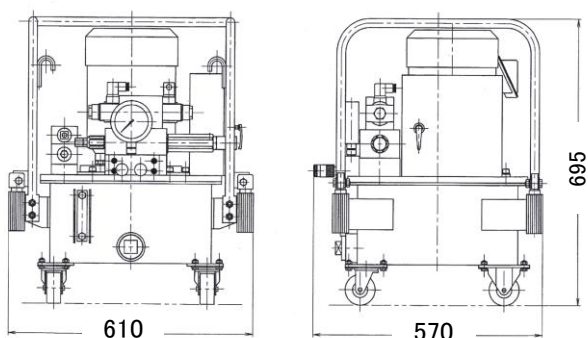

## < Specifications >

Model	HM-506		
Electric Motor	3.7kw 4P 380V – 460V		
Pump Type	High Pressure	Plunger Pump	
	Low Pressure	Trochoid Pump	
Pressure	High Pressure	Max	85MPa
		Limit	70MPa
	Midium Pressure	45MPa	
Oil Flow (50/60Hz)	High Pressure	2.6/3.3 L/min	
	Midium Pressure	5.6/7.0 L/min	
Tank Capacity	25L		
Weight	165kg		



## < Features >

- \* In-house developed, considering the balance of destructive power and operability of hydraulic machines.
- \* Surprisingly space-saving pump of the most compact footprint of 0.35m<sup>2</sup> and the highest maximum working pressure of 70MPa in the industry.
- \* Hirado Environmental Friendly Series (The Wall Crushers, The Wall Cutter, Splitter Series, etc.)

[www.hirado.co.in](http://www.hirado.co.in)



\* Specifications may change without any notice for product improvement.

HIRADO KINZOKU KOGYO CO., LTD.